



Contact ArmorDental
20 Camelot Dr.
Hingham, MA 02043
206.852.8427
info@armor-dental.com
www.armor-dental.com

Patients will be excited to use Mouth-Mate™!

Patients don't have in-home, post-operative products to help with their recovery at home, specifically around brushing near a surgical wound or mouth sore. As a consequence, patients are afraid to brush for fear of causing pain or damage to the area, so they avoid it entirely.

Patient Benefits

Mouth-Mate improves the patient experience and takes the fear away! **Mouth-Mate** gives your patients confidence and security to safely brush without pain so they can be compliant with their recovery instructions and keep their mouth clean to improve their healing.

Introducing Mouth-Mate!

Mouth-Mate is a new patented product that hovers over and protects mouth wounds and sores so patients can brush without pain, right at home! **Mouth-Mate** is as easy to use as a toothbrush, reduces pain during brushing and improves post-procedure oral care at home, which can reduce infections and promote healing. **Mouth-Mate** comfortably protects mouth wounds while brushing resulting in improved patient compliance and outcomes.



**92% Found
Mouth-Mate
Easy to Use**

At a recent clinical trial conducted with 100 patients, 92% found Mouth-Mate easy to use and significantly improved their at-home care.

Mouth-Mate comes in three different soft tip shapes that have been designed for use after the most frequent oral surgeries and dental procedures.

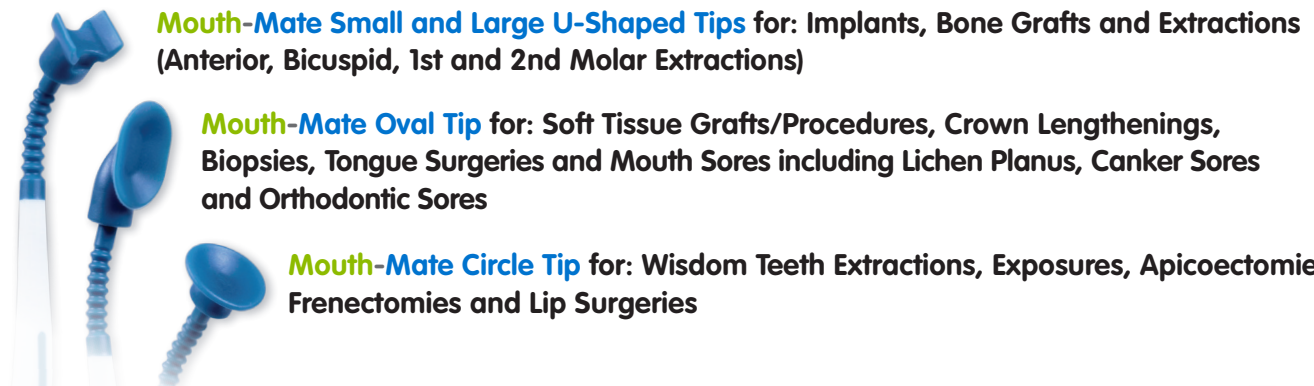

Mouth-Mate Small and Large U-Shaped Tips for: Implants, Bone Grafts and Extractions (Anterior, Bicuspid, 1st and 2nd Molar Extractions)

Mouth-Mate Oval Tip for: Soft Tissue Grafts/Procedures, Crown Lengthenings, Biopsies, Tongue Surgeries and Mouth Sores including Lichen Planus, Canker Sores and Orthodontic Sores

Mouth-Mate Circle Tip for: Wisdom Teeth Extractions, Exposures, Apicoectomies, Frenectomies and Lip Surgeries

Mouth-Mate is as easy to use as a toothbrush...

The patient can start using **Mouth-Mate** the **3rd day** after their surgical procedure and can be used for the duration of healing. Orthodontic patients can start using **Mouth-Mate** right after their procedure.

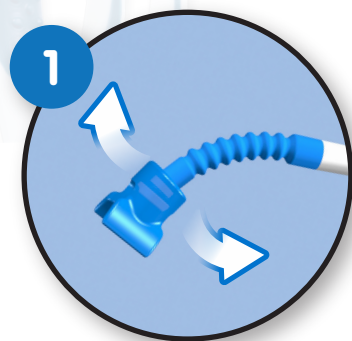

To start, bend the blue adjustable arm of **Mouth-Mate**'s handle so it can comfortably fit in your mouth.



Then simply shield the affected area by placing **Mouth-Mate** over the wound.



Once **Mouth-Mate** is positioned, and while keeping it in place without moving it, brush normally. You are only moving the toothbrush while **Mouth-Mate** protects the wound area. **Mouth-Mate** hovers over the wound, protecting it so you can brush with confidence and without pain.



ARMOR DENTAL

We're making it easier for you to help your patients heal better at home.

Armor Dental, whose mission is to modernize patient recovery at home, is a privately owned Boston based manufacturer of dental products that aid in the healing of post surgical wounds and chronic sores. Armor Dental is developing an entirely new category of dental hygiene products to protect oral wounds and canker sores anywhere in the mouth.